



The Napsbury

The Napsbury is a truly spacious family home, the ground floor has a sizeable lounge and separate open plan kitchen/dining and family room with large bi-fold doors leading to the garden, as well as under stair storage space. A first floor master bedroom has an en-suite bathroom, while three additional bedrooms and a shared bathroom help to complete the feel of a comfortable and roomy home.

4 Bedrooms

1,502 total sq ft

Upstairs

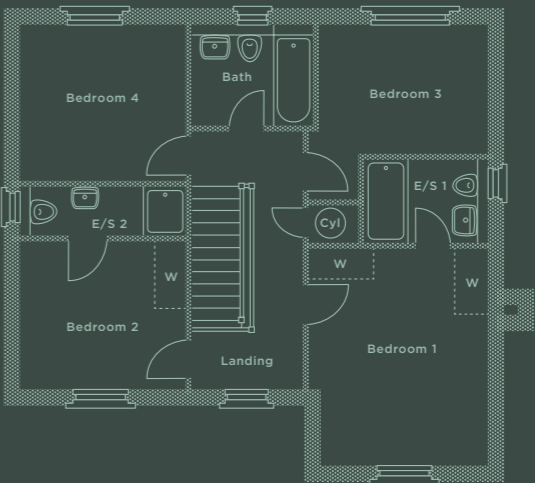

Downstairs

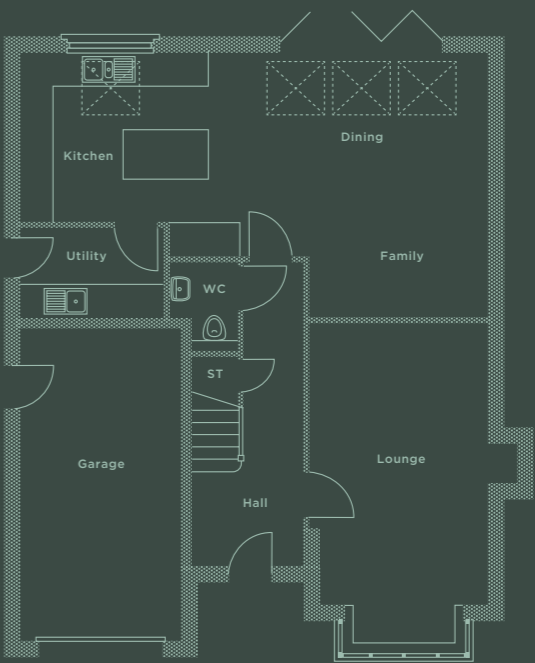

Lounge	3325 x 5990*	10'11" x 19'8"*	Bedroom 1	3375 x 4085*	11'1" x 13'5"*
Kitchen/			Ensuite 1	2260 x 1590	7'5" x 5'3"
Dining/Family	8790 x 4950*	28'10" x 16'3"*	Bedroom 2	3115 x 2790	10'3" x 9'2"
Utility	2670 x 1650*	8'9" x 5'5"*	Ensuite 2	3115 x 975	10'3" x 3'2"
Cloaks/WC	1275 x 1660*	4'2" x 5'5"*	Bedroom 3	3160 x 3275*	10'5" x 10'9"*
Garage	3015 x 6000*	9'11" x 19'8"*	Bedroom 4	3120 x 2890*	10'3" x 9'6"*
			Bathroom	2335 x 1880*	7'8" x 6'2"*

*Denotes maximum room dimensions.