

SHELBOURNE

— ESTATES —



The Adbury

A substantial family home with luxurious master bedroom, featuring an arched cathedral window and en suite shower room. Downstairs there is a separate dining room and cloakroom/wc.

4 Bedrooms

1,126 TOTAL SQ FT

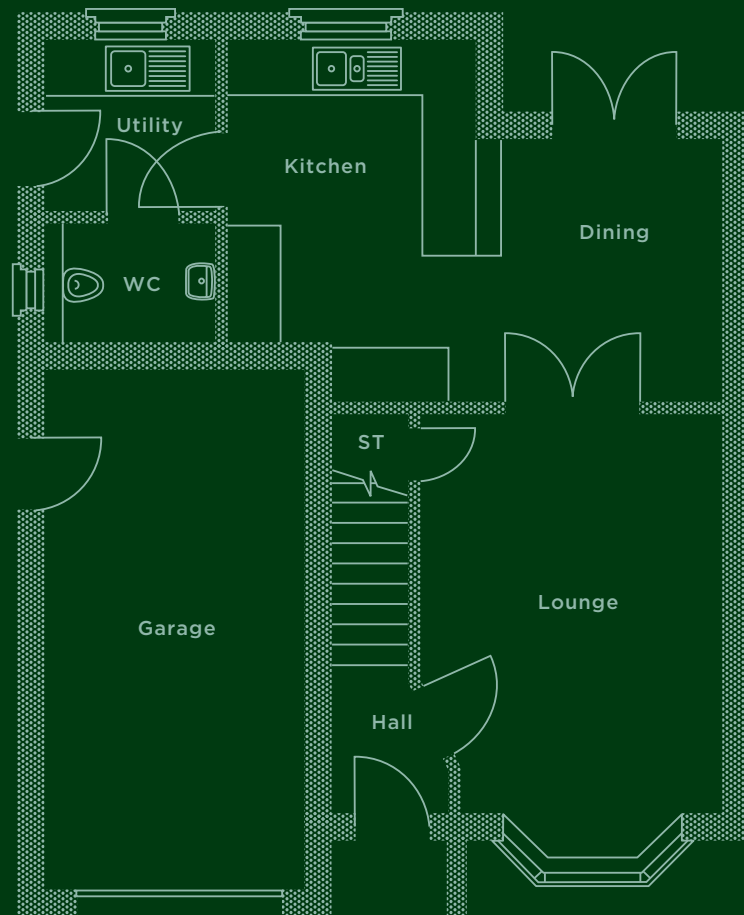

Downstairs

Lounge	3415* x 5000mm* 11'2"* x 16'5"*
Kitchen/ Dining	5600* x 4065mm* 18'4"* x 13'4"*
Utility	1940 x 1955mm 6'4" x 6'5"
Cloaks/WC	1940 x 1365mm 6'4" x 4'6"
Garage	3050* x 6100mm 10'0"* x 20'0"

Upstairs

Bedroom 1	4390* x 3130*mm 14'5"* x 10'3"*
En-suite	2260 x 1195mm 7'5" x 3'11"
Bedroom 2	3210 x 3810mm* 10'6" x 12'6"*
Bedroom 3	3200* x 2920mm* 10'6"* x 9'7"*
Bedroom 4	2260 x 3105mm 7'5" x 10'2"
Bathroom	2055 x 2010mm 6'9" x 6'7"

*Denotes maximum room dimensions.

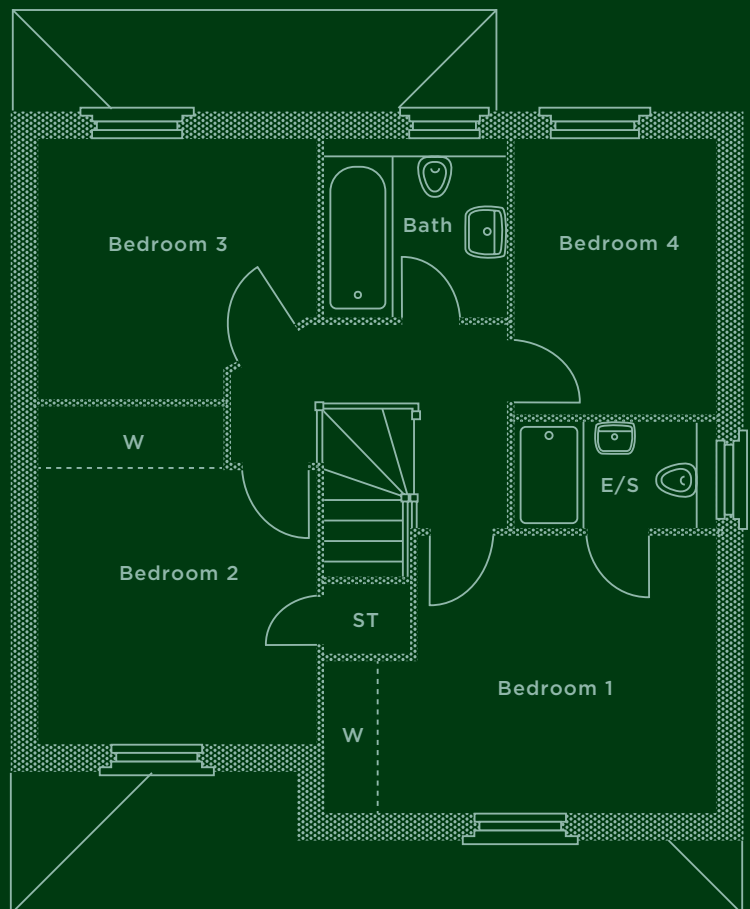

This is a computer generated image of The Adbury, elevation treatment may vary. All internal images are indicative of a Shelbourne house type. Room sizes are approximate and floorplans are not to scale. Plots may be handed and any garages may be single or double. Kitchen and bathroom layouts are indicative. These plans are correct at time of going to press, but may be subject to change during construction. Please ensure that you check for specific plot details. Speak to our Sales Advisor for individual parking configurations.