

SHELBOURNE

— ESTATES —



The Napsbury

The Napsbury is a truly spacious family home, the ground floor has a sizeable lounge and separate open plan kitchen/dining and family room with large bi-fold doors leading to the garden, as well as under stair storage space. A first floor master bedroom has an en-suite bathroom, while three additional bedrooms and a shared bathroom help to complete the feel of a comfortable and roomy home.

4 Bedrooms

1,502 TOTAL SQ FT

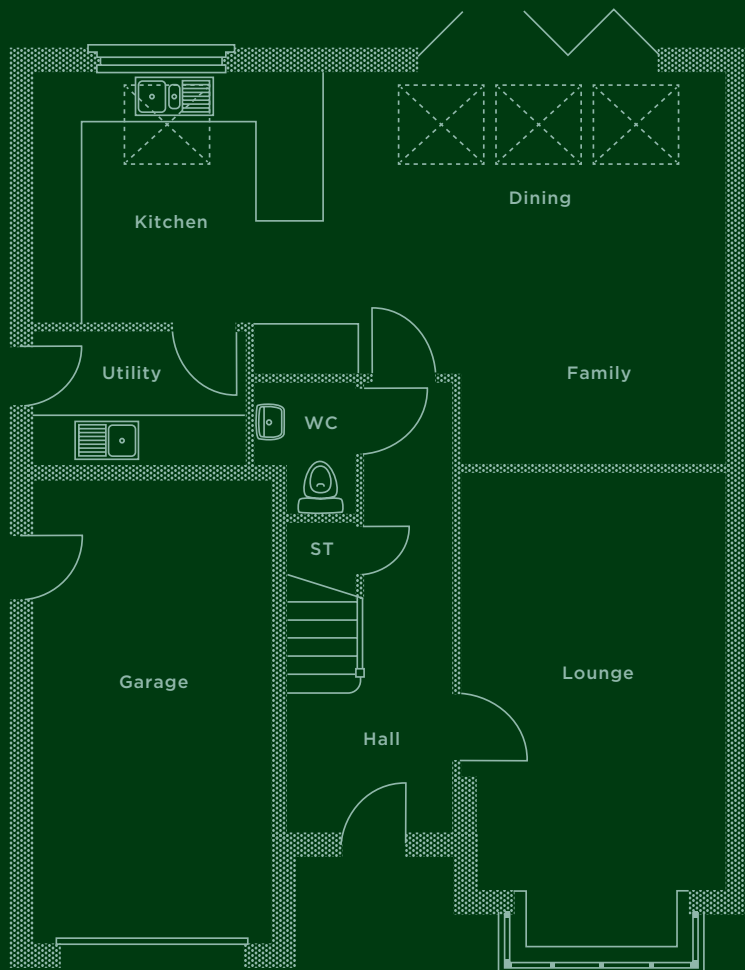

Downstairs

Lounge	3375* x 5990*mm 11'1"* x 19'8"*
Kitchen/Dining/ Family	8790* x 4950*mm 28'10"* x 16'3"*
Utility	2670 x 1650mm 8'9" x 5'5"
Cloaks/WC	1275* x 1665*mm 4'2"* x 5'5"*
Garage	3015 x 6000mm 9'11" x 19'8"

Upstairs

Bedroom 1	3355* x 4085*mm 11'0"* x 13'5"*
En-suite 1	2340 x 1590mm 7'8" x 5'3"
Bedroom 2	3130 x 2790mm 10'3" x 9'2"
En-suite 2	3130 x 975mm 10'3" x 3'2"
Bedroom 3	3365* x 3175*mm 11'0"* x 10'5"*
Bedroom 4	3130 x 2890mm 10'3" x 9'6"
Bathroom	2115 x 1880mm 6'11" x 6'2"

*Denotes maximum room dimensions.

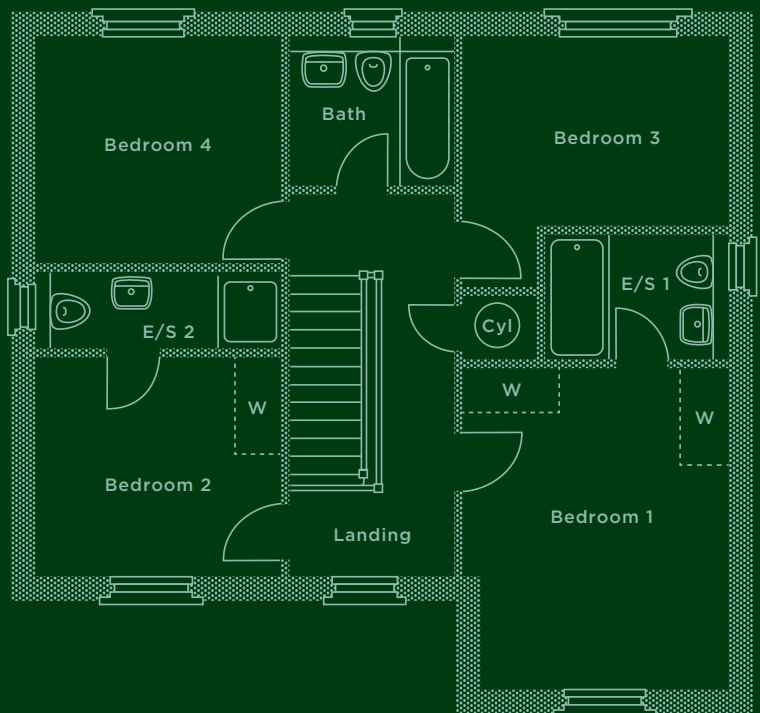

This is a computer generated image of The Napsbury, elevation treatment may vary. All internal images are indicative of a Shelbourne house type. Room sizes are approximate and floorplans are not to scale. Plots may be handed and any garages may be single or double. Kitchen and bathroom layouts are indicative. These plans are correct at time of going to press, but may be subject to change during construction. Please ensure that you check for specific plot details. Speak to our Sales Advisor for individual parking configurations.