

SHELBOURNE

— ESTATES —



The Oxhill

Echoes of classic Victorian-era architecture lead into this superb home designed for contemporary lifestyles. A stylish kitchen/dining/family room spans the full width of the Oxhill, with bi-folding doors opening out to the garden for that perfect blend of indoor/outdoor living. With a generous lounge, separate study and a utility, plus 4 well-planned bedrooms including the master bedroom with ensuite shower room, the Oxhill is an exceptional home.

4 Bedrooms

1,498 TOTAL SQ FT

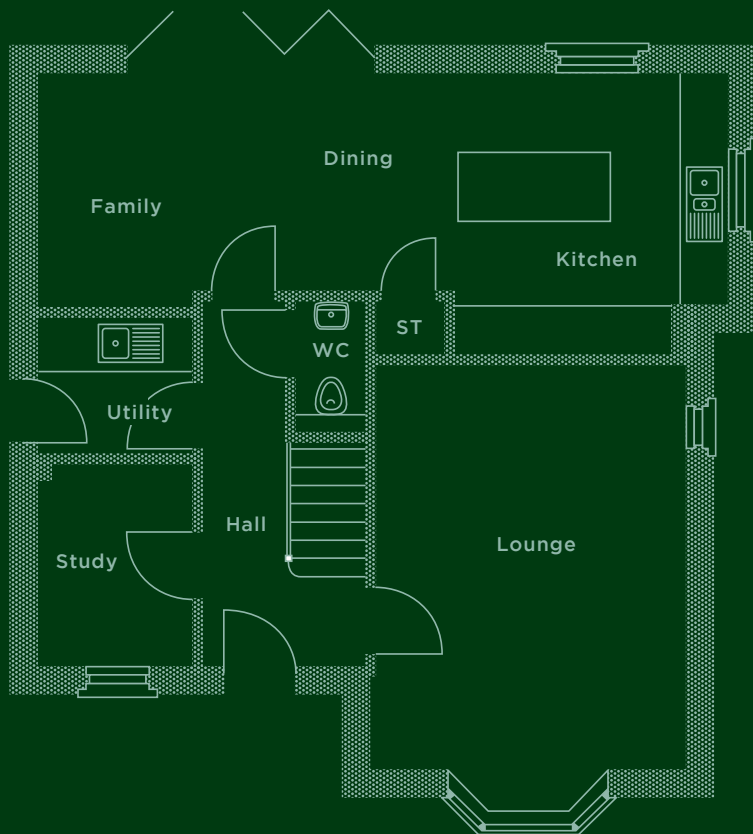

Downstairs

Lounge	4000* x 5600*mm 13'1"* x 18'4"*
Family/Dining/ Kitchen	8755* x 3550*mm 28'9"* x 11'8"*
Study	1950 x 2550mm 6'5" x 8'4"
Utility	1950 x 1700mm 6'5' x 5'7"
Cloaks/WC	890 x 1715mm 2'11" x 5'7"

Upstairs

Bedroom 1	3960* x 3820*mm 13'0"* x 12'6"*
Ensuite 1	2910 x 1925*mm 9'7" x 6'4"*
Bedroom 2	4150* x 4350*mm 13'7"* x 14'3"*
Ensuite 2	1910 x 1475mm 6'3" x 4'10"
Bedroom 3	3465* x 3160*mm 11'4"* x 10'5"*
Bedroom 4	2735* x 3065*mm 9'0"* x 10'1"*
Bathroom	2375 x 1965mm 7'10" x 6'5"

*Denotes maximum room dimensions.

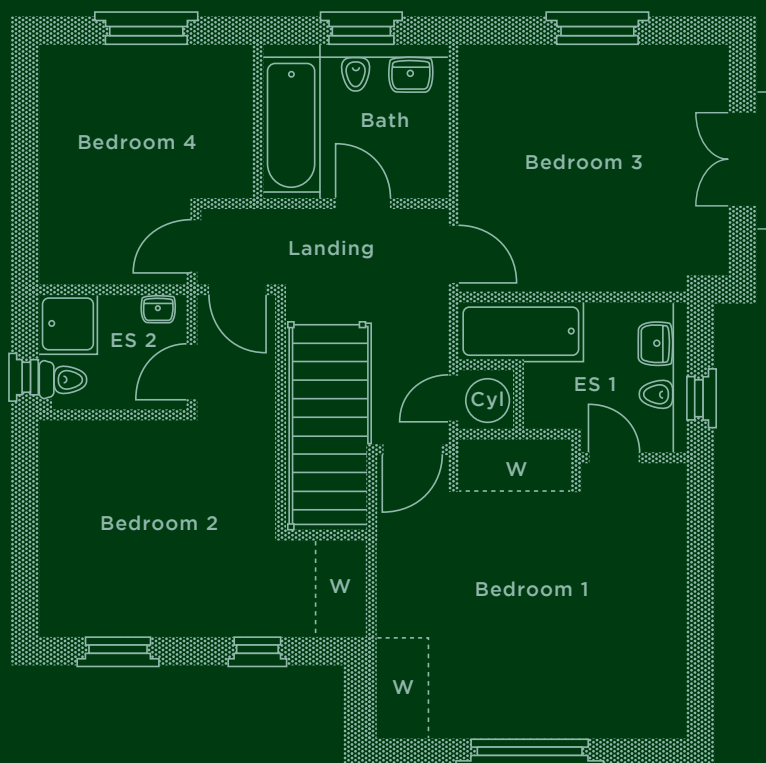

This is a computer generated image of The Oxhill, elevation treatment may vary. All internal images are indicative of a Shelbourne house type. Room sizes are approximate and floorplans are not to scale. Plots may be handed and any garages may be single or double. Kitchen and bathroom layouts are indicative. These plans are correct at time of going to press, but may be subject to change during construction. Please ensure that you check for specific plot details. Speak to our Sales Advisor for individual parking configurations.